

Sectional View of Stairs/Entrance and Walkway (D-D).

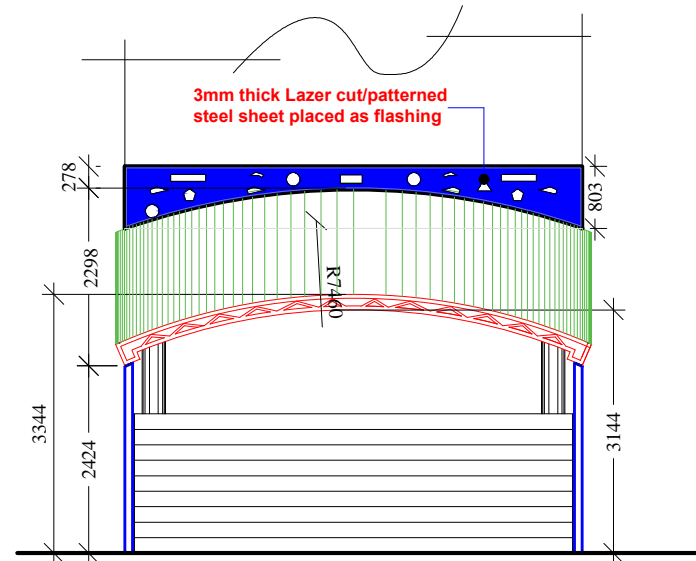

Entrance cover into the main building front view

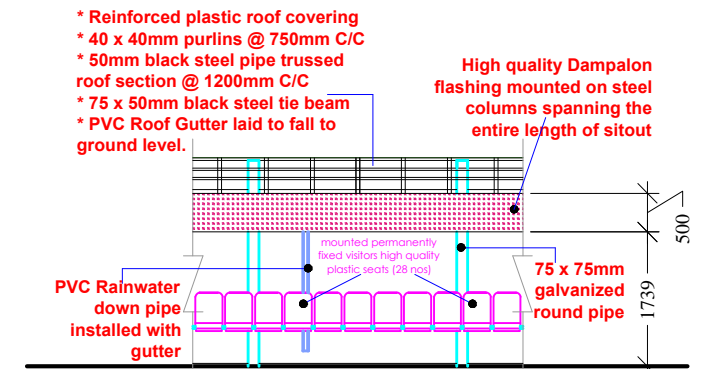

Approach View of external entrance/visitors sitting.

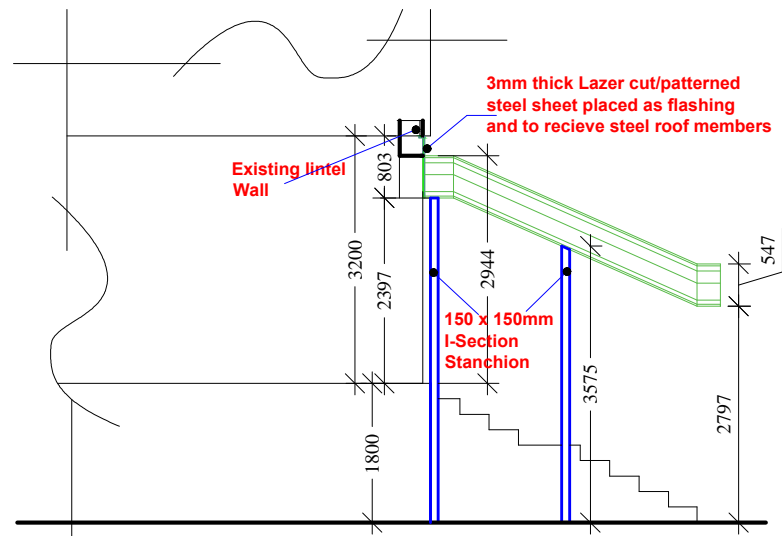

Sectional Side View of Stairs/Entrance (C-C).

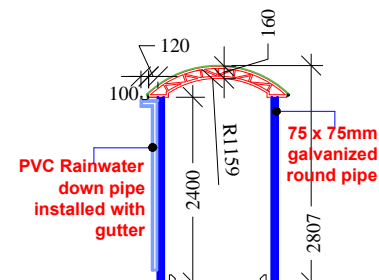

Sectional View of Walkway (A-A).

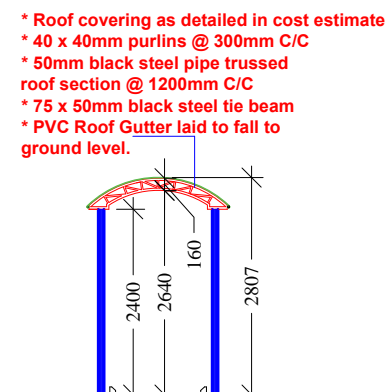

Sectional View of Walkway (B-B).

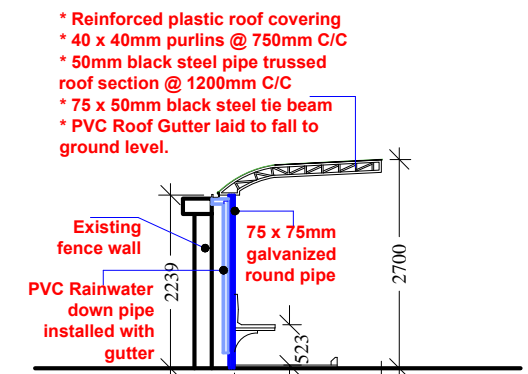

Sectional View of external entrance/visitors sitting roof covering (E-E).

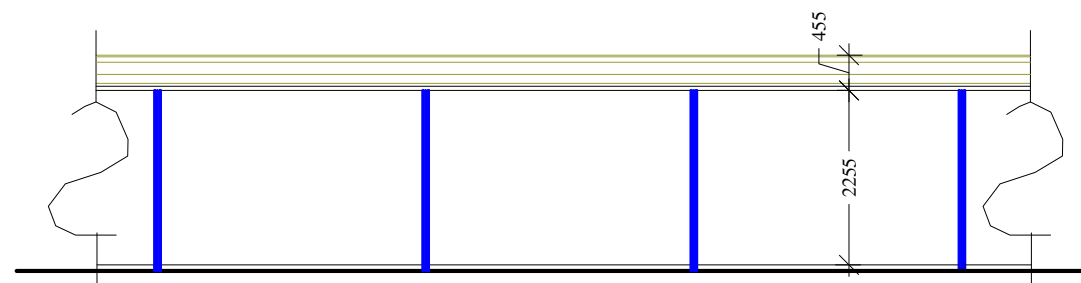

Walkway cover side view